

# Aligator® Giant Gutter Installation Guide

## General Guidance

### Preparation

Fascia boards should be in good condition, level and in linear alignment (straight). If required, packing shim plates should be fixed behind gutter brackets to achieve good alignment. The fascia should be capable of supporting the gutter when full of water, ice or snow.

Where gutter is fixed to PVC-ue cellular fascia board, it is recommended that a timber support framework is installed behind the fascia to provide a straight and secure fixing surface.

Use standard metal work tools to cut or drill aluminium gutters. Angle grinders are not recommended. Where gutter or fittings are polyester powder coated, cut edges should be deburred and repainted with touch up paint, SC880.

### Gutter position

Gutters must be installed level or to a fall of 1:600. The gutter should not be positioned at a level which causes rainfall to overshoot the gutter, i.e. too low, or where it is damaged by the high velocity impact of sliding snow, i.e. too high.

### Snowloading

Heavy snowfall coupled with highly insulated roofs is causing accumulation of snow on roofs. A sudden thaw will then cause the snow to slide down the roof and rest against the gutters if they are fixed too high. Greater care must be taken to make sure the gutters will not impede sliding snow. However, for the ultimate protection, snow guards must be installed.

### Jointing

Joint sealing must not be carried out in wet weather or in temperatures below 5°C or above 40°C. Joint surfaces must be perfectly clean and dry. Use a clean cloth and solvent cleaner SC108 to remove all traces of dirt or grease, which may not be visible.

Ensure that the gutter joint sockets/spigots are correctly aligned with each other to ensure free thermal movement within the gutter joint.

Only Alutec high performance low modulus sealant SC101 must be used. Use of other sealants may result in early joint failure. Sealant over nine months old must not be used.

### Fixing

To ensure the long term durability of aluminium gutter systems, it is vitally important to ensure that the fixing components are equally durable and capable of providing the necessary support. They must therefore be non corrosive, of a compatible material to ensure no electrolytic corrosion occurs and of the appropriate size. Only the recommended austenitic stainless steel screws must be used to fix gutters, whether direct, fascia or rafter bracket fixed.

If fixing to fascia boards made of materials other than wood or Alutec aluminium composites, please call the Alutec Technical Services Department.

### Testing

On completion of an installation, blank off all gutter outlets. Fill gutter to  $\frac{3}{4}$  full and leave for 5 minutes, then check for leakage. Discharging the flood test water into rainwater pipes will identify any leaks in rainwater pipe joints. Any joints that fail should be taken apart, all sealant cleaned off, then re-sealed and re-tested.

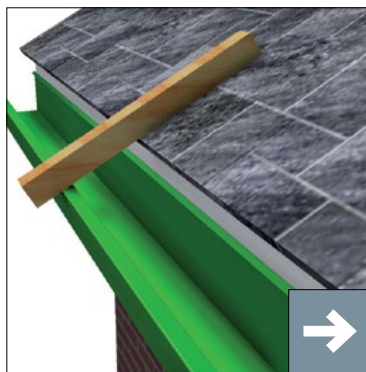

1. Set gutter height by laying a straight batten on the lowest profile of the roof. Place the gutter under the batten so that they are touching and mark the top lip. Use a chalk line or equivalent to set level as a reference for fixing gutters.

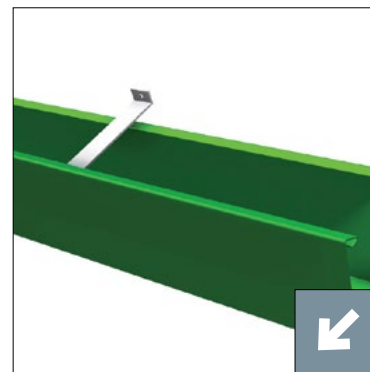

2. Secure stiffener brackets into the top front recess of the gutter in line with the pre-drilled holes at 750mm centres.



3. Clean all jointing surfaces with a clean cloth and Alutec solvent cleaner, code SC108.

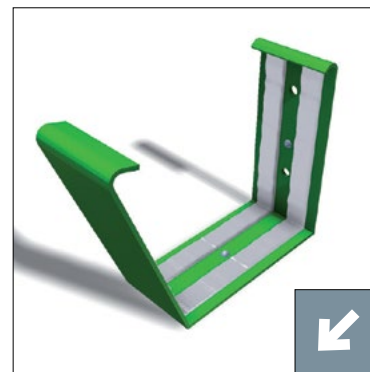

4. Check that factory fitted rubber compression spacers are fitted, then apply two 8mm parallel beads of Alutec sealant, code SC101 to both sides of the union.

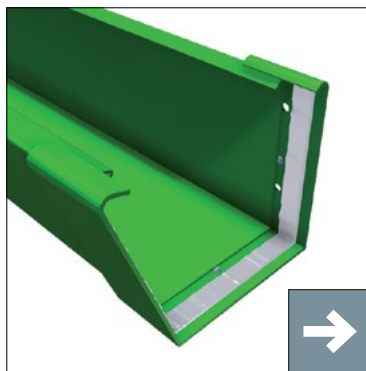

5. Fit the union to the end of the gutter by placing it onto the rear gutter edge first, bend in slightly the front face of the gutter and clip the union over the gutter's front edge.

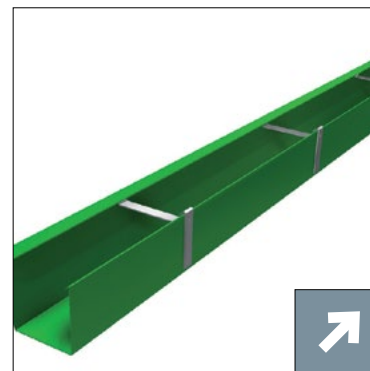

6. Hook rear spacer assemblies over rear upstand of gutter in line with pre-drilled holes and stiffener brackets.

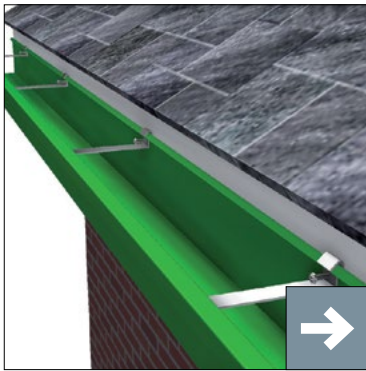

7. Fix the gutter to the fascia through the stiffener bracket fixing holes using Alutec 50mm x No. 12 screw, code SC231 and Alutec washer, code SC521.

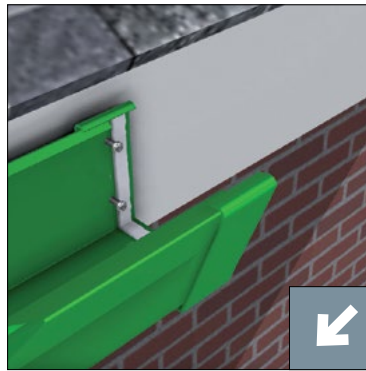

8. Anchor the unions and angles to the fascia using Alutec 32mm x No. 10 screw, code SC202.

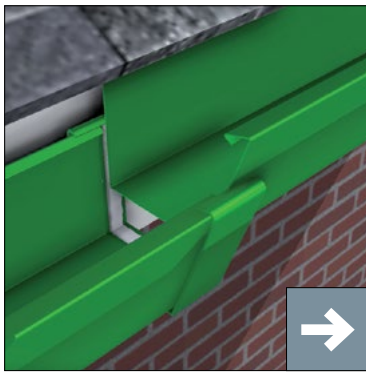

9. Repeat steps 2, 3, 4, 5, & 6. Clip next gutter section into place, ensure a 3-4mm expansion gap and then fix gutter as described in step 7.

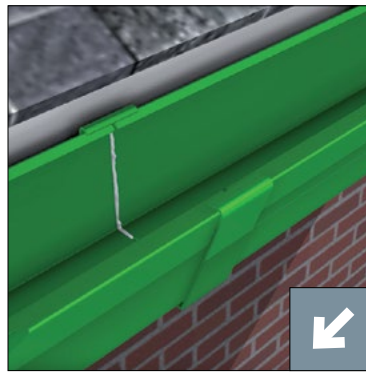

10. Add additional sealant if required and point any excess sealant well into the expansion gap. Dress sealant level with faces of gutter.

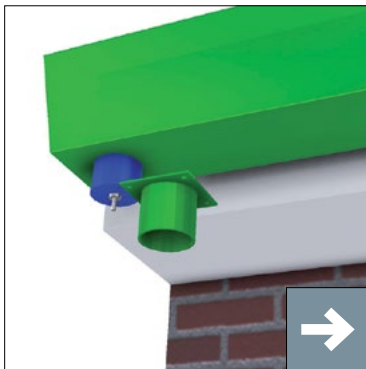

11. Fit patch outlet by cutting the appropriate size hole in-situ or prior to gutter fixing. Place patch outlet on the external face of the gutter, mark and drill four 6mm bolt holes. Apply Alutec sealant, code SC101 to joint faces and fix with the four supplied Alutec M6 aluminium bolts, nuts and washers, codes SC502, SC511 & SC521.



12. Clean off any excess sealant to visible surfaces using Alutec solvent cleaner, code SC108.